

Tubular Handles

Stainless Steel

SPECIFICATION

Handle tube

Stainless steel AISI 304, wall thickness 2 mm
Ground, matte shiny finish

Handle legs

Stainless steel precision casting AISI CF-8
Matte shot-blasted

INFORMATION

With the tubular handles GN 333.6, the handle legs and the handle tube are pressed together.

A typical application for tubular handles is on double-winged doors for machines or devices.

TECHNICAL INFORMATION

- Load Rating Information (see page A35)
- Stainless Steel Characteristics (see page A26)

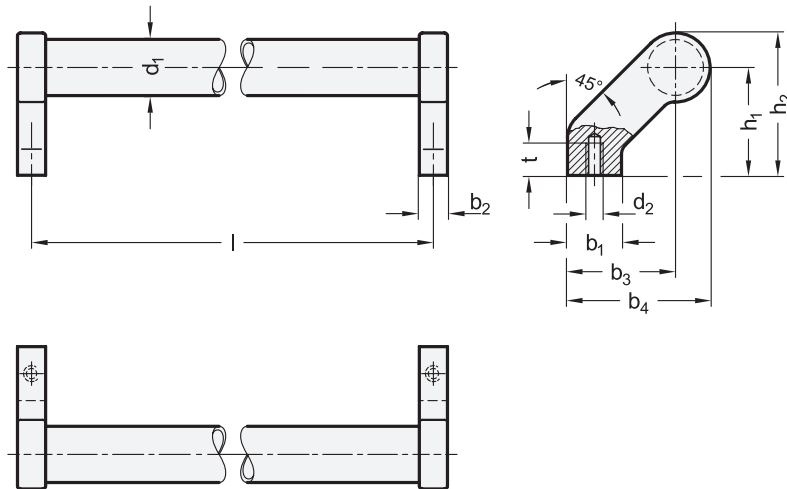

GN 333.6

STAINLESS STEEL

Description	d ₁	Length l	b ₁	b ₂	b ₃	b ₄	d ₂	h ₁	h ₂	t min.	△
GN 333.6-28-200	28	200	25	14	50	66	M 8	50	66	15	605
GN 333.6-28-250	28	250	25	14	50	66	M 8	50	66	15	670
GN 333.6-28-300	28	300	25	14	50	66	M 8	50	66	15	730
GN 333.6-28-400	28	400	25	14	50	66	M 8	50	66	15	845
GN 333.6-28-500	28	500	25	14	50	66	M 8	50	66	15	980
GN 333.6-28-600	28	600	25	14	50	66	M 8	50	66	15	1060

